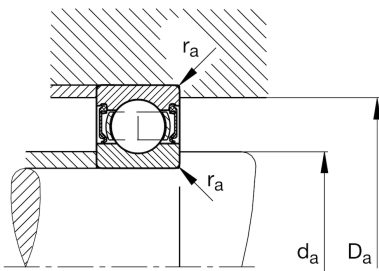
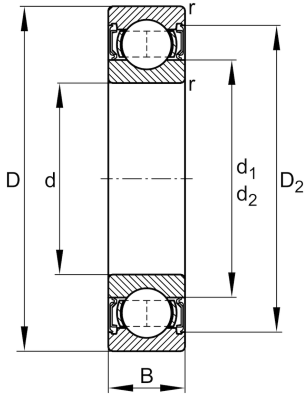

**FAG****6207-RSR**

Deep groove ball bearing

Schaeffler ID:  
0167203340000Deep groove ball bearing 62...-RSR, single  
row, seal, steel sheet metal cage

## Technical information

**Main Dimensions & Performance Data**

d	1,378 in	Bore diameter
D	2,835 in	Outside diameter
B	0,669 in	Width
$C_r$	6.182,554 lbf	Basic dynamic load rating, radial
$C_{0r}$	3.439,748 lbf	Basic static load rating, radial
$C_{ur}$	213,579 lbf	Fatigue load limit, radial
$n_G$	5.900 1/min	Limiting speed
	0,613 lbs	Weight

**Mounting dimensions**

$d_{a \min}$	1,654 in	Minimum diameter shaft shoulder
$D_{a \max}$	2,559 in	Maximum diameter of housing shoulder
$r_{a \max}$	0,039 in	Maximum fillet radius

**Dimensions**

$r_{\min}$	0,043 in	Minimum chamfer dimension
$D_2$	2,494 in	Caliber diameter outer ring
$d_1$	1,858 in	Shoulder diameter inner ring

**Temperature range**

$T_{\min}$	-22 °F	Operating temperature min.
$T_{\max}$	212 °F	Operating temperature max.

**Calculation factors**

$f_0$	13,8	Calculation factor
-------	------	--------------------