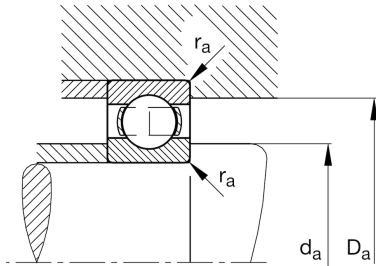
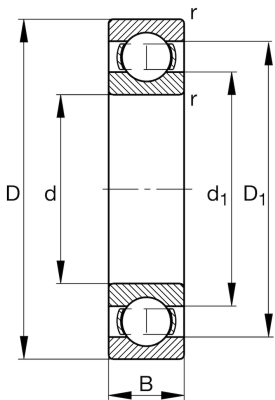

**FAG****6204-N**

Deep groove ball bearing

Schaeffler ID:  
0167197600000Deep groove ball bearing 62...-N, single  
row, ring groove, steel sheet metal cage

## Technical information

**Main Dimensions & Performance Data**

d	0,787 in	Bore diameter
D	1,85 in	Outside diameter
B	0,551 in	Width
$C_r$	3.057,554 lbf	Basic dynamic load rating, radial
$C_{0r}$	1.483,813 lbf	Basic static load rating, radial
$C_{ur}$	102,293 lbf	Fatigue load limit, radial
$n_G$	22.100 1/min	Limiting speed
$n_{gr}$	16.300 1/min	Reference speed
	0,209 lbs	Weight

**Mounting dimensions**

$d_{a \min}$	1,008 in	Minimum diameter shaft shoulder
$D_{a \max}$	1,63 in	Maximum diameter of housing shoulder
$r_{a \max}$	0,039 in	Maximum fillet radius

**Dimensions**

$r_{\min}$	0,039 in	Minimum chamfer dimension
$D_1$	1,514 in	Shoulder diameter outer ring
$d_1$	1,132 in	Shoulder diameter inner ring

**Temperature range**

$T_{\min}$	-22 °F	Operating temperature min.
$T_{\max}$	248 °F	Operating temperature max.

**Calculation factors**

$f_0$	13,1	Calculation factor
-------	------	--------------------