

10-24 UNC-2B, THRU
.03 X 45° CHAM REQD
6 HOLES AT 60°
ON A 120.65Ø
4.750

SET SCREW
.312-24 2 AT 90°

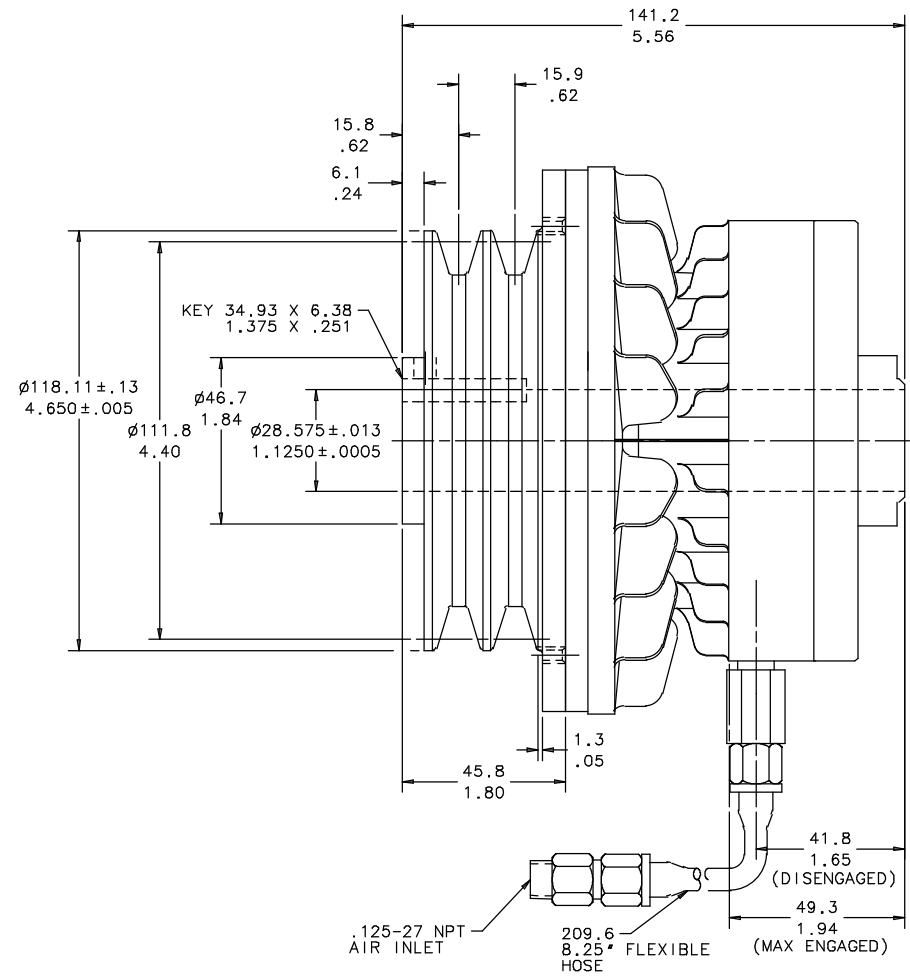
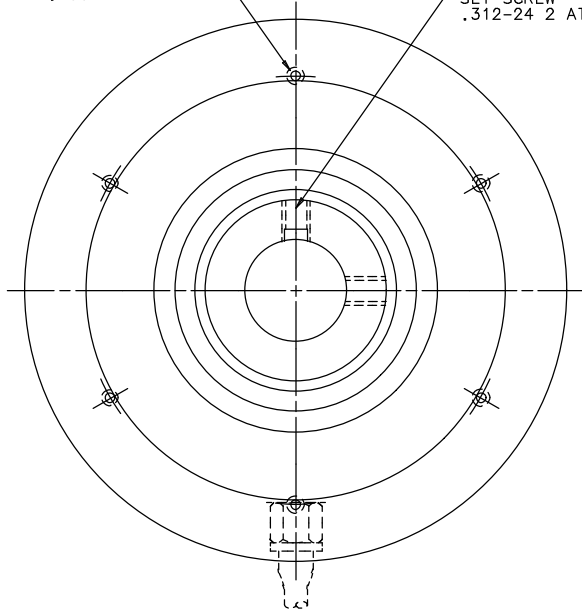

NOTES:
1. SHEAVE "A" 2 GROOVE

GEOMETRIC TOLERANCE VALUES		THIRD ANGLE PROJECTION	
MM	INCH		
.013	.0005		
.03	.001		
.05	.002		
SURFACE ROUGHNESS VALUES			
µm	µin		
.08	.003	6.3	250
.13	.005	3.2	125
.20	.008	1.6	63
.25	.010	0.8	32
.38	.015	0.4	16
		0.2	8

UNLESS OTHERWISE SPECIFIED
1. SURFACE TEXTURE: ✓
2. METRIC TOLERANCES: X ±0.8; .X ±0.5; .XX ±0.13
INCH TOLERANCES: .XX ±.02; .XXX ±.005
3. ANGLES ±.5°
4. PRIMARY DIMENSIONS ARE IN MM
SECONDARY DIMENSIONS ARE IN INCHES
5. REMOVE ALL BURRS AND SHARP EDGES
6. DO NOT SCALE DWG - WORK TO DIMS
7. PART MUST CONFORM TO ENGINEERING STANDARD WORK INSTRUCTIONS

		Nexen Group, Inc.	
TITLE GENERAL DIMENSIONS			
MODEL L-600			
MATL #	A 14370	02-03-00	
REV	ECO	ERO	DATE
DWN	KGC	DATE 02-03-00	SCALE: NONE WAS 2589
CHKD	CDV	DATE 02-03-00	SHEET 1 OF 1
APVD	AM	DATE 02-03-00	C-805250S A

C-805250S